

Woodfield Road, Crawley, RH10 8AE

Asking Price £450,000

Council Tax Band: D



LOCATION

We are delighted to bring to the market this spacious, well presented three bedroom semi-detached property in a highly convenient location in Northgate Crawley. Just a stones throw from Manor Royal business complex, less than a mile to Three Bridges station, and just over three miles to London Gatwick, it is very well positioned if you require any of the above for work. In addition, the 200 bus to the airport stops opposite the house which is very convenient and the town centre is just over a mile away with its large range of shops and eateries.



Open House Horsham

Ground Floor
Approx. 52.2 sq. metres (561.4 sq. feet)

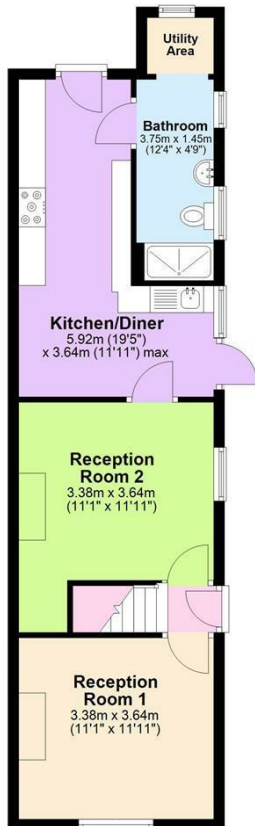

First Floor
Approx. 28.3 sq. metres (304.9 sq. feet)



Second Floor
Approx. 25.1 sq. metres (270.6 sq. feet)

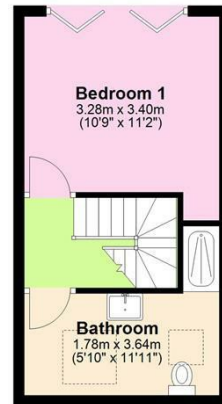

Total area: approx. 105.6 sq. metres (1136.9 sq. feet)
Woodfield Road

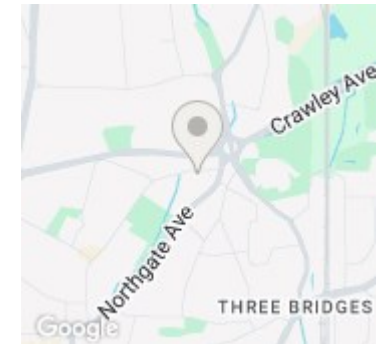

Energy Efficiency Rating		
	Current	Potential
Very energy efficient - lower running costs		
(92 plus) A		
(81-91) B		
(69-80) C		
(55-68) D		
(39-54) E	57	72
(21-38) F		
(1-20) G		
Not energy efficient - higher running costs		
England & Wales	EU Directive 2002/91/EC	